

OCXD SERIES

- Oven Controlled Oscillator
- 12.0 Volt
- SC Crystal
- $\pm 1\text{ppb}$ to $\pm 50\text{ppb}$

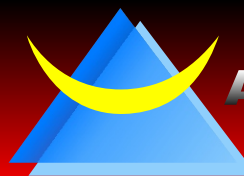

ASCEND

FREQUENCY DEVICES

Electrical Specifications

Frequency Range:	-	1.000MHz, 50.000MHz, and 10.000MHz
Frequency Stability:	-	$\pm 1\text{ppb}$ to $\pm 50\text{ppb}$
Operating Temperature Range:	-	0°C to +50°C to -40°C to +85°C
Storage Temperature Range:	-	-40°C to +95°C
Output Type:	-	Sinewave
Supply Voltage (Vdd):	-	12Vdc
Supply Current:	-	120mA Typical, 450mA Maximum
Warm-up Time:	at 25°C	30 Minutes
Input Impedance:	-	100K Ohms Typical
Crystal:	-	SC Cut
Phase Noise (at 10MHz):	10Hz Offset	-113dBc
	100Hz Offset	-135dBc
	1000Hz Offset	-140dBc
	10KHz Offset	-155dBc
	100KHz Offset	-155dBc
Voltage Control:	0 to VCC	$\pm 0.75\text{ppm}$ Typical
Aging:	after 30 days	$\pm 0.1\text{ppm/year}$

Mechanical Dimensions

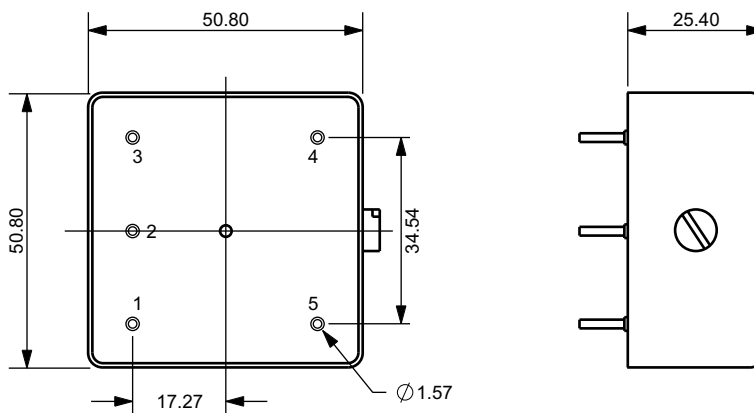

ALL DIMENSIONS
IN MILLIMETERS

Pad	FUNCTION
1	Vc
2	+5Vdc
3	Output
4	Ground
5	Supply Voltage

Part Numbering Guide

OCXD 12 S 050 A 2 - 33.000M

Series

5 Pin OCXO, 2" Square

Supply Voltage

12 = 12.0V

Output Type

S = Sinewave

Frequency Stability

001 = $\pm 1\text{ppb}$
 005 = $\pm 5\text{ppb}$
 010 = $\pm 10\text{ppb}$
 050 = $\pm 50\text{ppb}$

Frequency

Crystal Cut

2 = SC Cut

Operating Temperature Range*

A = +0°C to +50°C
 B = -10°C to +60°C
 C = -20°C to +70°C
 D = -30°C to +70°C
 E = -30°C to +80°C
 F = -40°C to +85°C

* All Stabilities not available